

Site Location Map

Parsvnath
Committed to build a better world

Royal Kingdom beckons you.....

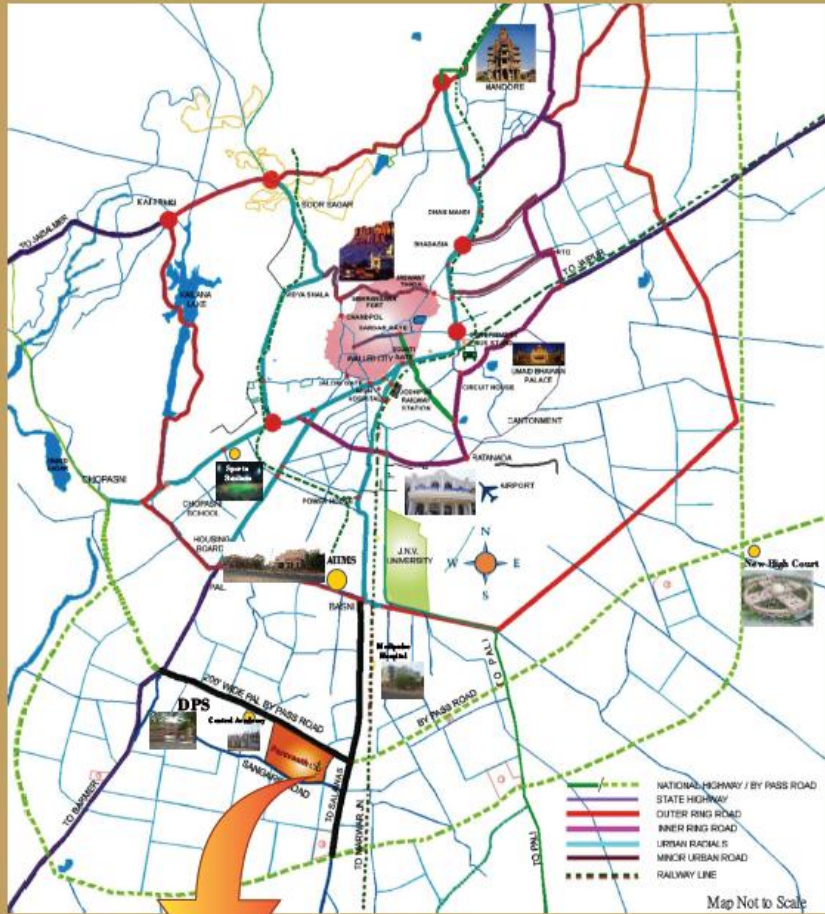

Parsvnath city
Jodhpur



Parsvnath Developers Ltd.

Site address :Parsvnath City,Pal-sangaria bye pass, 200 feet wide road, Near Sangaria Fatak, Sangaria, Jodhpur, Ph.: +91-8890112000

Corp. Office : 6th Floor, Arunachal Building, 19, Barakhamba Road, New Delhi-110001.
Ph.: 011-43686600, 43684800, Fax: 011-43686646

Regd. Office : Parsvnath Metro Tower, Near Shahdara Metro Station, Shahdara, Delhi-110032
Ph.: 011-43050100, 43010500, Fax: 011-43050473, For Sales Enquiry No: (011) - 30969301

Visit us at: www.parsvnath.com, E-mail: residentialsales@pasvnath.com

Parsvnath city
Jodhpur

Parsvnath City, Jodhpur is an ultra modern township equipped with modern infrastructure and high-end recreational facilities- an experience of grandiose life.



Things of desire....

Magnificent landscapes
 Modern club equipped with gym, and sport facilities
 Ear marked plots for Shopping Malls / Hotels
 Multi Speciality Hospitals near by
 Repute educational institutes are at close proximity with a wide range of cultural & sporting opportunities.



Its all for you.....

Planned development of over 100 acres.
 Strategically located in the vicinity of major Industrial areas-Basni, Sangaria & Boranada.
 DPS School, AIIMS & reputed Hospitals/ High Court/ other facilities near by. Also enjoy good connectivity to the site via 200 ft. Pal Road, By-Pass on one side and 100 ft. Sangaria road on the other Side.

Actual Site photograph

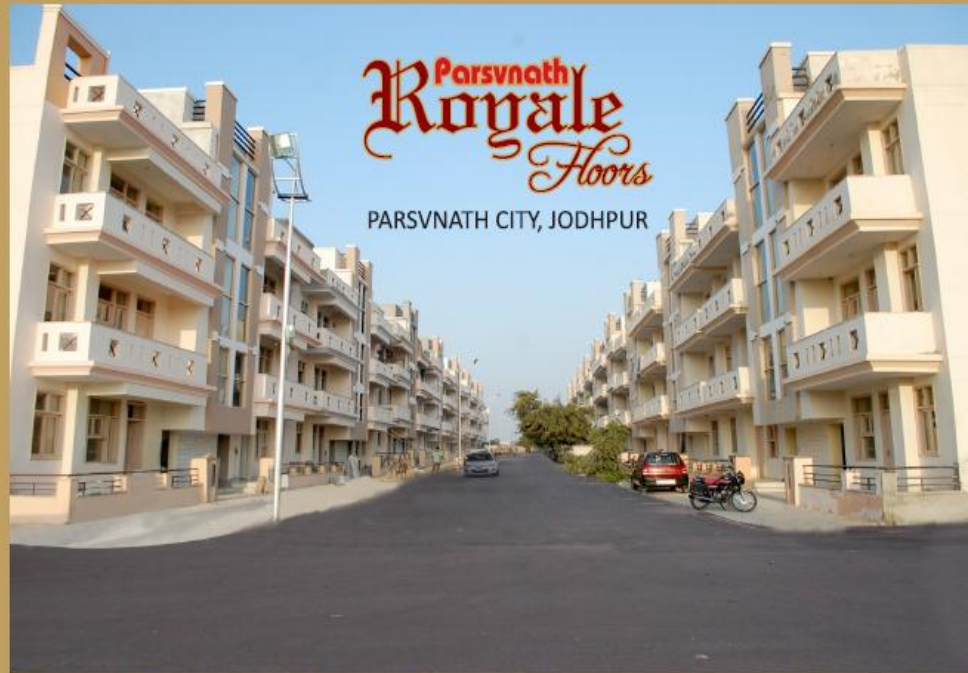

Parsvnath City is an aesthetically designed and well planned township which captures the true spirit of Jodhpur. Equipped with modern infrastructure and high end recreational facilities, the township is a self-contained mini-city. Complete Infrastructure, Sufficient Power, Modern Amenities, Provision for parks, Convenient shopping , Shopping Mall and Hotel etc are some of the prime features of this ultra modern township.

Actual Site photographs



Specifications

Structure

Earthquake - resistant/ semi R.C.C frame structure with brick filler walls as per IS codes

Flooring

Vitrified flooring with border in drawing-dining, kitchen and in all bedrooms.
 Non skid tiles in bathrooms and balconies.

Painting

Oil bound distemper with pleasing shades on the apartment walls with POP cornices in drawing/dining & bedroom.

Dado

Glazed/Ceramic tiles up to 7 feet in the bathrooms in different colours.

Exterior

Textured paint finished as per architectural drawings.

Kitchen

Slabs are of well-finished granite stone with stainless steel sink (single bowl) with drain board. Glazed tile dado on wall up to 2 ft. over counter.

Doors & Windows

Decorative panel doors in entrance and flush doors (35mm) with complete fittings. Frames are in Sal/Chap wood. All fittings are aluminum powder coated. Doors in bathrooms are laminated inside.

Bathrooms

Equipped with washbasins, mirrors and WCs in varied shades. Chrome plated tap fittings of superior make. Provisions of hot & cold water supply.

Electrical

Electrical (copper) wiring as per ISI code with Modular switches. Circuits with MCBs of approved make. TV and telephone points in each bedroom.



Actual Site photographs



Parsvnath Royale Floors

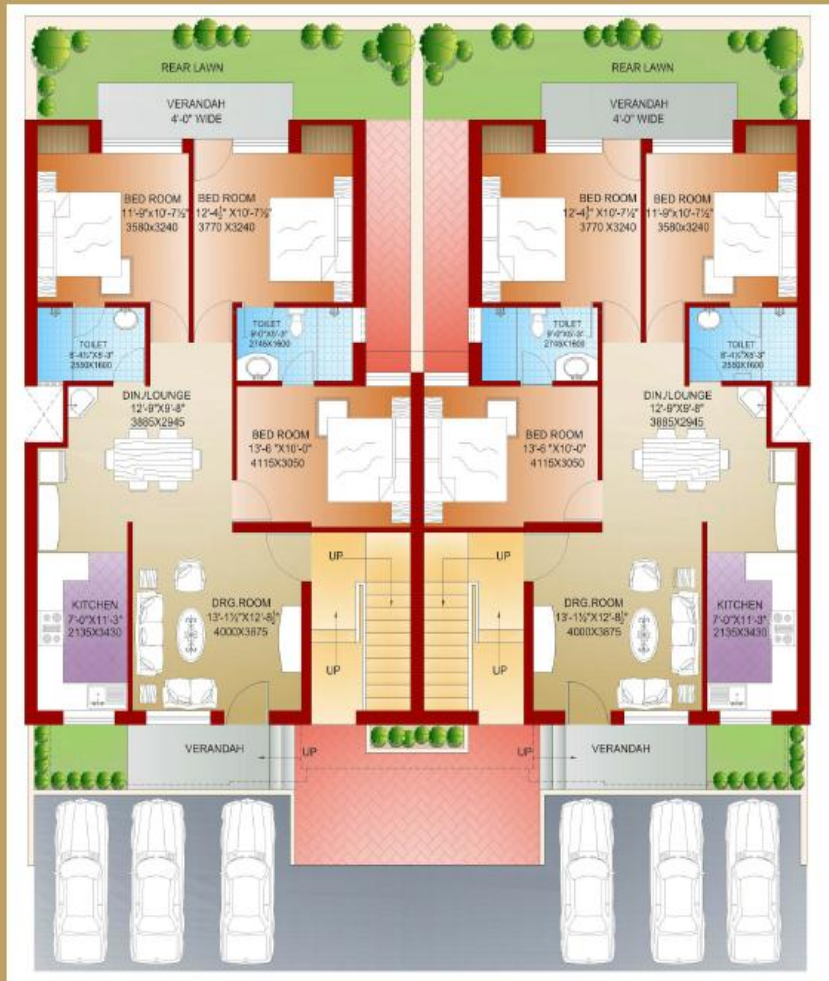

Plot Size - 200 Sq. Yds. (167.20 Sq. Mtr.)

Type - B

Ground & Typical Floor Plan

Super Area - 1350 Sq. Ft. (125.42 Sq. Mtr.)

Accommodation - 3 Bedrooms, Drawing / Dining, Kitchen, 2 Toilets, Verandahs or Balconies

Parsvnath Royale Floors

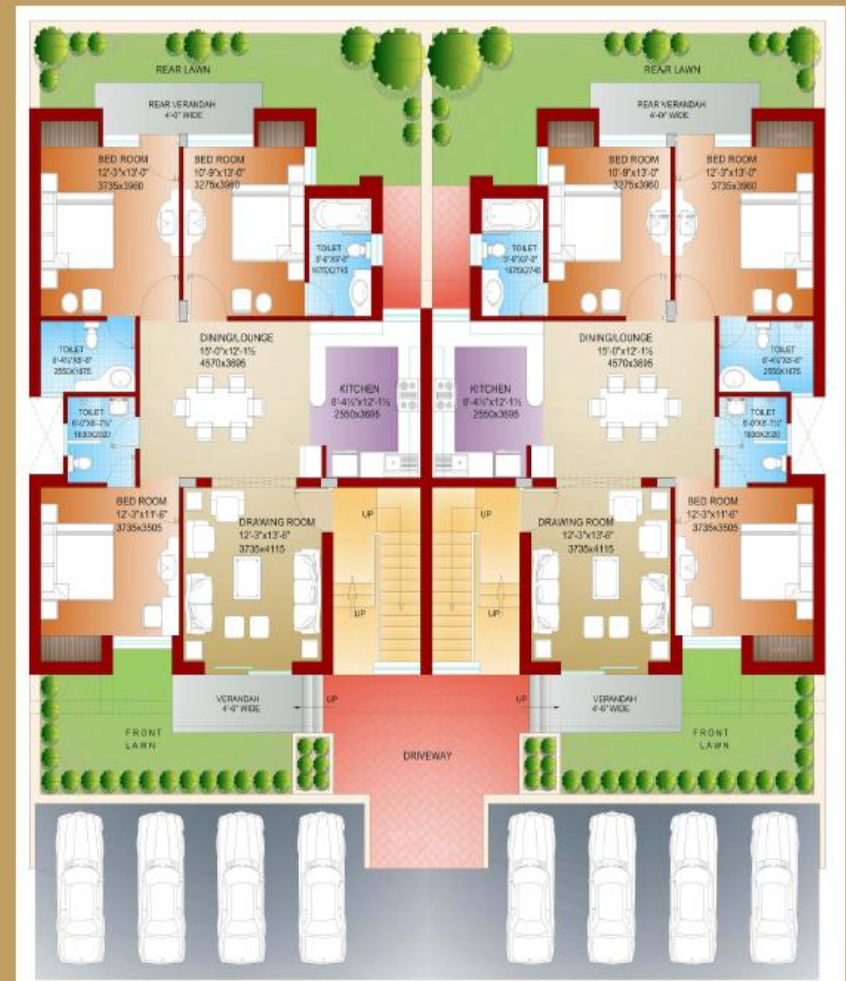

Plot Size - 250 Sq. Yds. (209 Sq. Mtr.)

Type - A

Ground & Typical Floor Plan

Super Area - 1530 Sq. Ft. (142.14 Sq. Mtr.)

Accommodation - 3 Bedrooms, Drawing / Dining, Kitchen, 3 Toilets, Verandahs or Balconies