

Welcome
a fresh wave of luxury

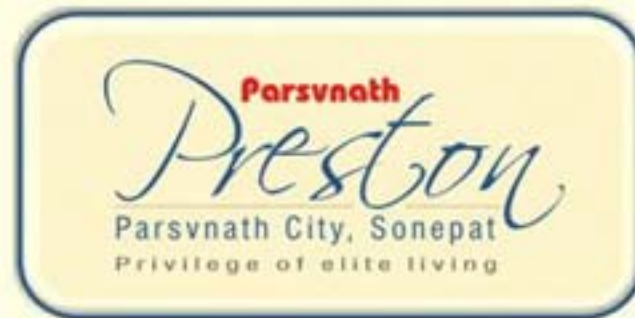

Parsvnath
Preston

Parsvnath City, Sonapat
Privilege of elite living

Location Map





Parsvnath City

Unveiling a new world North of Delhi

A new wave of development is all set to transform the lifestyle of North of Delhi. Coming up at one of the finest locations on N.H-1, just 17 kms. from Delhi border, Parsvnath City, Sonapat is a landmark which is well connected with most the destinations of North Delhi.

With lush green, pollution free environment, best of contemporary urban planning and wide array of academic, health care institutions and lifestyle avenues, Parsvnath City, Sonapat presents a distinct choice of lavish lifestyle which is truly global.



-
- Located at Parsvnath City, Sonapat
 - Convenient connectivity to major landmarks of Delhi
 - Well planned and wide approach roads
 - Neo-rich neighbourhood of elite projects
 - Academic institutions and health care facilities
 - World class shopping, leisure and amusement getaways nearby

Parvathi
Preston
Parvathi City, Gopapat
Privilege of elite living



Perspective shown is an artistic impression.

Give rise to your imagination

Coming up in this world class integrated township, Parsvnath City, Sonapat, is Parsvnath Preston – an adorable choice of affluent group housing. Parsvnath Preston will offer the prospective residents a distinct choice of two, three and four bedroom apartments – each one of them designed to perfection with excellent space management, ergonomic interiors and adorable amenities.

All this encapsulated in a breathtaking expanse of captivating landscapes which are adorned with beautiful plantation, boulevards and water bodies. This superb amalgam ensures that the residents enjoy the finest quality of life for lifetime.



-
- Choice of 2/3/4 bedroom apartments
 - Clutter free approach
 - Excellent architectural synergy
 - Affluent amalgam of amenities

Parvathi
Preston
Parvathi City, Sonapat
PRIVILEGE OF URBAN LIVING



Perfection shown in an artistic impression.

Security for a blooming life

The vast park at Parsvnath Preston is a paradise for the little ones, where they swing, slide and indulge in various other games of their preferences. All under the strict vigilance of three-tier security arrangements. This sense of security within the complex gives you a relaxing time and faith of a carefree life.



-
- Three-tier security
 - car parking



Grab Your Slice of Opulence

The drawing room at Parsvnath Preston is super-spacious and opens to a panoramic view of the highly vegetated nearby areas. Open the window, and a gush of fresh air fills you from within.



This luxuriously furnished space is the perfect place for small gathering of near & dear ones and evidently depicts your class.

-
- Drawing-&-Dining room with attached balconies
 - Rich specifications

Parvath
Preston
Parvath City, Sonapat
Privilege at elite living



Prospective shown is an artistic impression



NIGHT VIEW OF ENTRY GATE



STEPPED LANDSCAPE



PATHWAY WITH PERGOLA



CENTRAL LANDSCAPE



WATERBODY

Note: Layout plan, club building & Landscape plan are tentative subject to change as per architecture need



LEGEND	
FORM 1, 2, 3, 4, 5, 6, 7, 8, 9, 10, 11, 12, 13, 14, 15, 16, 17, 18, 19	As per drawing
FORM 1	As per drawing
FORM 2	As per drawing
FORM 3	As per drawing
FORM 4	As per drawing
FORM 5	As per drawing
FORM 6	As per drawing
FORM 7	As per drawing
FORM 8	As per drawing
FORM 9	As per drawing
FORM 10	As per drawing
FORM 11	As per drawing
FORM 12	As per drawing
FORM 13	As per drawing
FORM 14	As per drawing
FORM 15	As per drawing
FORM 16	As per drawing
FORM 17	As per drawing
FORM 18	As per drawing
FORM 19	As per drawing
FORM 20	As per drawing
FORM 21	As per drawing
FORM 22	As per drawing
FORM 23	As per drawing
FORM 24	As per drawing
FORM 25	As per drawing
FORM 26	As per drawing
FORM 27	As per drawing
FORM 28	As per drawing
FORM 29	As per drawing
FORM 30	As per drawing
FORM 31	As per drawing
FORM 32	As per drawing
FORM 33	As per drawing
FORM 34	As per drawing
FORM 35	As per drawing
FORM 36	As per drawing
FORM 37	As per drawing
FORM 38	As per drawing
FORM 39	As per drawing
FORM 40	As per drawing
FORM 41	As per drawing
FORM 42	As per drawing
FORM 43	As per drawing
FORM 44	As per drawing
FORM 45	As per drawing
FORM 46	As per drawing
FORM 47	As per drawing
FORM 48	As per drawing
FORM 49	As per drawing
FORM 50	As per drawing
FORM 51	As per drawing
FORM 52	As per drawing
FORM 53	As per drawing
FORM 54	As per drawing
FORM 55	As per drawing
FORM 56	As per drawing
FORM 57	As per drawing
FORM 58	As per drawing
FORM 59	As per drawing
FORM 60	As per drawing
FORM 61	As per drawing
FORM 62	As per drawing
FORM 63	As per drawing
FORM 64	As per drawing
FORM 65	As per drawing
FORM 66	As per drawing
FORM 67	As per drawing
FORM 68	As per drawing
FORM 69	As per drawing
FORM 70	As per drawing
FORM 71	As per drawing
FORM 72	As per drawing
FORM 73	As per drawing
FORM 74	As per drawing
FORM 75	As per drawing
FORM 76	As per drawing
FORM 77	As per drawing
FORM 78	As per drawing
FORM 79	As per drawing
FORM 80	As per drawing
FORM 81	As per drawing
FORM 82	As per drawing
FORM 83	As per drawing
FORM 84	As per drawing
FORM 85	As per drawing
FORM 86	As per drawing
FORM 87	As per drawing
FORM 88	As per drawing
FORM 89	As per drawing
FORM 90	As per drawing
FORM 91	As per drawing
FORM 92	As per drawing
FORM 93	As per drawing
FORM 94	As per drawing
FORM 95	As per drawing
FORM 96	As per drawing
FORM 97	As per drawing
FORM 98	As per drawing
FORM 99	As per drawing
FORM 100	As per drawing

SITE LAYOUT PLAN

	2 BEDROOM APARTMENTS
	3 BEDROOM APARTMENTS
	3 BR + S & 4 BR + S APARTMENTS

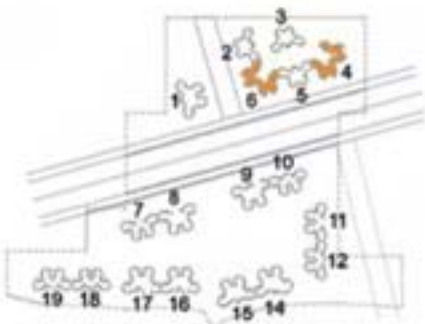

KEY PLAN



**2 Bedroom Unit
 (Tower No.- 4 & 6)**

**SALEABLE AREA = 1310 SQ. FT (Unit NO. -3 & 4)
 SALEABLE AREA = 1265 SQ. FT (Unit No. - 1,2,5 & 6)**

Note:
 1. Plans are tentative & subject to approval.
 2. Architectural features may vary as per architects design.
 3. All areas are shown as super area and subject to change as per design.

4 Bedroom + S. Room Unit

SALEABLE AREA = 2550 SQ. FT. (Unit No. 2 & 3)

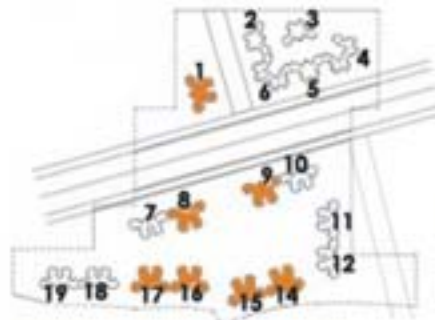

KEY PLAN



3 Bedroom + S. Room Unit

SALEABLE AREA = 1900 SQ. FT (Unit No. 1 & 4)
 (Tower No. 1, 8, 9, 14, 15, 16, & 17)

- Note :
1. Plans are tentative & subject to approval.
 2. Architectural features may vary as per architects design.
 3. All areas are shown as super area and subject to change as per design.

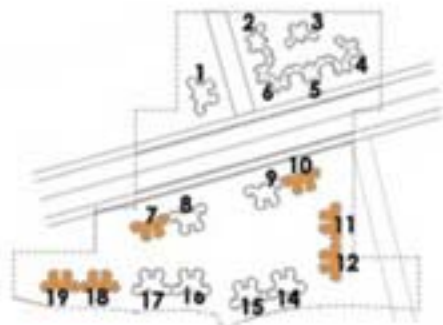

KEY PLAN



3 BED ROOM UNIT

[Tower No.- 7, 10, 11, 12, 18 & 19]

SALEABLE AREA = 1700 SQ. FT. (Unit NO. -2 & 3)
SALEABLE AREA = 1765 SQ. FT. (Unit No. - 1 & 4)

Note :
 1. Plans are tentative & subject to approval.
 2. Architectural features may vary as per architects design.
 3. All areas are shown as super area and subject to change as per design.

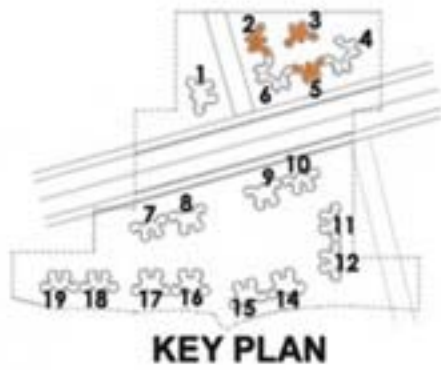

SALEABLE AREA = 1265 SQ. FT.(Unit No. 1 & 4)
SALEABLE AREA = 1310 SQ. FT.(Unit No. 2 & 3)

Note :
 1. Plans are tentative & subject to approval.
 2. Architectural features may vary as per architects design.
 3. All areas are shown as super area and subject to change as per design.

Specifications



Structure designed for highest seismic considerations stipulated by the code, for better safety.

Living / Dining

- * Floor Imported Marble
- * Walls Oil bound Distemper.
- * Ceiling Oil bound Distemper.

All Bed rooms

- * Floor Imported laminated wooden flooring in bed rooms
Vitrified tiles flooring in one bed room
- * Walls Oil Bound Distemper
- * Ceiling Oil Bound Distemper

Kitchen

- * Walls Tiles 2'-0" above Counter level with Oil Bound Distemper in the balance area
- * Floor Combination of one or more of Vitrified Tiles / Ceramic-tiles / Marbles / Stone.
- * Counter Granite
- * Fitting / fixtures CP fittings from premium range of Standard brands, Single stainless steel sink with drain board.

Balcony

- * Floor Combination of one or more of Vitrified tiles / Ceramic-Tiles / Marble / Stone .
- * Ceiling / Walls Exterior textured paint

Toilets

- * Walls Combination of one or more of Vitrified tiles / Ceramic-Tiles / Marble / Mirror / Oil bound distemper
- * Floor Combination of one or more of Vitrified tiles / Marble
- * Counters Granite
- * Fittings / Fixtures CP fittings of standard brands.

S. Room (wherever applicable)

- * Floor Ceramic tiles/ Stone
- * Walls Dry Distemper
- * Ceiling dry Distemper
- * Toilet conventional fittings and fixtures

Doors and Windows

- * Entrance doors Veneered & Polished flush shutter door with hard wood rame.
- * Internal doors Polished Hardwood Frame with Veneered Flush Doors
- * External Doors and Windows Powder Coated Aluminum

- Hardware** All hardware & hinges in stainless steel / brass
All doors except in the toilet to be provided with the mortice lock.

- Electrical** Modular switches
100% power back up.

- Security system** Intercom facility with CC. Camera from the entrance of the complex.

Lift lobby

- * Floor Combination of one or more of Indian Marble / granite
- * Walls Combination of one or more of Marble / Granite cladding / Oil Bound Distemper.

- Connectivity** Broad band Internet Connectivity

Note: Specifications are tentative which may vary as decided by the Company / Architect



Parswanth
Preston
Parswanth City, Sonapat
Privilege of elite living



Perspective shown is an artistic impression

Parvath
Preston
Parvath City, Sonapat
Privilege of white living



The emergence of a new era in development

The incredible foresight and financial acumen of Parsvnath Developers Limited are wholly focused on strategic growth. Since its inception, it has created edifices of magnificence throughout the length and breadth of the country.

This ISO 9001, 14001 & OHSAS 18001 certified company is India's first real estate company to have a NAREDCO-ICRA DR2 rating.

An impressive line-up of over 100 projects across Andhra Pradesh, Delhi, Goa, Gujarat, Haryana, Jharkhand, Jammu & Kashmir, Karnataka, Kerala, Madhya Pradesh, Maharashtra, Punjab, Rajasthan, Tamil Nadu, Uttar Pradesh, Uttarakhand & West Bengal.

Today, Parsvnath has become a synonym for perfection, innovation, customer satisfaction,



Parsvnath Developers Ltd.

Committed to build a better world

1st Indian Real Estate Company with NAREDCO ICRA DR 2- Rating • ISO 9001, 14001 & OHSAS 18001 Certification

Site Office :

Parsvnath Preston, Parsvnath City, Sector 8, NH-1, Sonapat (Haryana) Ph: +91-130-3200147

Regd. & Corp. Office:

6th Floor, "Arunachal" 19, Barakhamba Road, New Delhi-110001,

Ph.: +91-11-43586001/2, +91-11-23350120, +91-11-23310198, Fax: +91-11-23315400

E-mail: residentialsales@parsvnath.com, Web site: www.parsvnath.com

Regional & Branch Offices

Andhra Pradesh: Regional Office: **Hyderabad:** Amar House, 3rd Floor, 6-3-1229/2, Raj Bhawan Road, Somajiguda, Hyderabad, Ph: +91-40-23314302, **Goa:** Regional Office: **Panaji:** Dempo Trade Centre, Flat No.701, 11 EDC Complex, Patto, Panaji Ph: +91-832-2437855, **Gujarat:** Regional Office: **Ahmedabad:** A. 604, Shapath Iv, 5G Highway, Opp. Kamavati Club, Ahmedabad, Ph: +91-79-30075700, 40081450, **Haryana:** Regional Office: **Chandigarh:** SCO-1, 1st Floor, Sector-26, Madhya Marg, Chandigarh, Ph: +91-172-5025301-3, **Jammu & Kashmir:** Regional Office: **Jammu:** B. 111, First Floor, South Block, Bahu Plaza, Jammu, Ph: +91-191-2474074/75, **Karnataka:** Regional Office: **Bangalore:** 3rd Floor, Jubilee Building, 45, Museum Road, Bangalore, Ph: +91-80-6613065/52/54, **Kerala:** Regional Office: **Cochin:** Hari House No 26/1232, K.P. Vallan Road, Kadaventha PO, Cochin, Ph: +91-484-2310993, 6522282, **Madhya Pradesh:** Regional office: **Indore:** First Floor, Khandekhal Millers Building, 9/1/2 M.G. Road, Indore-452001 Ph: +91-731-2524040 / 2524050, Branch office: **Ujjain:** Parsvnath City, Dewas Road, Ujjain-456010 Ph: +91-734-2526910/11, **Maharashtra:** Regional Office: **Mumbai:** 706-708, Balarama Building, 7th Floor, Bandra Kurla Complex, Bandra (E), Mumbai 400051 Ph: +91-22-26592980/81/82, Fax: +91-22-26591929, Branch Office: **Pune:** Nucleus Mall, 404, 4th Floor, 1 Church Road, Opp. Pune Commissioner's Office, Pune-1, Ph: +91-20-40064260, 40064161, 40064162, **Punjab:** Regional Office: **Chandigarh:** SCO-1, 1st Floor, Sector-26, Madhya Marg, Chandigarh, Ph: +91-172-5025301-3, **Rajasthan:** Regional Office: **Jaipur:** C-18, Silver Square Building, 3rd Floor, 19-23 & 27-29, Bhagwan Das Road, C-Scheme, Near Raj Mandir, Jaipur-302001, Ph: +91-141-3203917, 2378198/99, Branch Office: **Jodhpur:** Sabu Towers, 2nd Floor, 2, Choparani Road, Jodhpur-342003, Ph: +91-291-5105061, **Tamilnadu:** Regional Office: **Chennai:** No. 15, Old No.6, Conolagh Road, 2nd Lane, Teynampet, Chennai - 600 018, Ph: 044 - 24336480, 61 , 62, **Uttarakhand:** Regional Office: **Dehradun:** 103, Rajpur Road, Dehradun - 248001, Ph: +91-135-2744205, **Uttar Pradesh:** Regional Office: **Lucknow:** 1st Floor, Nikhlesh Palace, 17/4, Ashok Marg, Lucknow-226001, Ph: +91-522-4016317/324/325, Branch Office: **Agra:** 1st Floor, Church Road Mall, Church Road, Ram Nagar Colony, Agra, Telefax: +91-562-2521578, 3242193/94, Branch Office: **Saharanpur:** Parsvnath Plaza, Court Road, Saharanpur, Ph: +91-132-2731363/64, Branch Office: **Moradabad:** Parsvnath Plaza, Mansarovar Scheme, Delhi Road, Moradabad, Ph: +91-591- 2481015, 2486029

24x7 Customer Care, Call : +91-11-32616357



Integrated Townships - Group Housing - Hotels - Shopping Malls - Office Spaces - Educational Institutes - Serviced Apartments - IT Parks - SEZs